

**ABBREVIATIONS**

AA	ADJUSTED POINT	DA	DEVELOPMENT AREA
AB	ADJACENT	DB	DEVELOPMENT BANK
AC	ADJACENT PROPERTY	DC	DEVELOPMENT CONTROL ORDER
AD	ADJACENT ROAD	DD	DEVELOPMENT DRAINAGE
AE	ADJACENT SITE	DE	DEVELOPMENT EASEMENT
AF	ADJACENT STREET	DF	DEVELOPMENT FENCE
AG	ADJACENT TOWN	DG	DEVELOPMENT TOWN
AH	ADJACENT WALL	DH	DEVELOPMENT WALL
AI	ADJACENT WATER	DI	DEVELOPMENT WATER
AJ	ADJACENT WOOD	DJ	DEVELOPMENT WOOD
AK	ADJACENT ZONE	DK	DEVELOPMENT ZONE
AL	ADJACENT ZONE	DL	DEVELOPMENT ZONE
AM	ADJACENT ZONE	DM	DEVELOPMENT ZONE
AN	ADJACENT ZONE	DN	DEVELOPMENT ZONE
AO	ADJACENT ZONE	DO	DEVELOPMENT ZONE
AP	ADJACENT ZONE	DP	DEVELOPMENT ZONE
AQ	ADJACENT ZONE	DQ	DEVELOPMENT ZONE
AR	ADJACENT ZONE	DR	DEVELOPMENT ZONE
AS	ADJACENT ZONE	DS	DEVELOPMENT ZONE
AT	ADJACENT ZONE	DT	DEVELOPMENT ZONE
AV	ADJACENT ZONE	DV	DEVELOPMENT ZONE
AW	ADJACENT ZONE	DW	DEVELOPMENT ZONE
AX	ADJACENT ZONE	DX	DEVELOPMENT ZONE
AY	ADJACENT ZONE	DY	DEVELOPMENT ZONE
AZ	ADJACENT ZONE	DZ	DEVELOPMENT ZONE
BA	ADJACENT ZONE	DB	DEVELOPMENT ZONE
BB	ADJACENT ZONE	DB	DEVELOPMENT ZONE
BC	ADJACENT ZONE	DB	DEVELOPMENT ZONE
BD	ADJACENT ZONE	DB	DEVELOPMENT ZONE
BE	ADJACENT ZONE	DB	DEVELOPMENT ZONE
BF	ADJACENT ZONE	DB	DEVELOPMENT ZONE
BG	ADJACENT ZONE	DB	DEVELOPMENT ZONE
BH	ADJACENT ZONE	DB	DEVELOPMENT ZONE
BI	ADJACENT ZONE	DB	DEVELOPMENT ZONE
BJ	ADJACENT ZONE	DB	DEVELOPMENT ZONE
BK	ADJACENT ZONE	DB	DEVELOPMENT ZONE
BL	ADJACENT ZONE	DB	DEVELOPMENT ZONE
BM	ADJACENT ZONE	DB	DEVELOPMENT ZONE
BN	ADJACENT ZONE	DB	DEVELOPMENT ZONE
BO	ADJACENT ZONE	DB	DEVELOPMENT ZONE
BP	ADJACENT ZONE	DB	DEVELOPMENT ZONE
BQ	ADJACENT ZONE	DB	DEVELOPMENT ZONE
BR	ADJACENT ZONE	DB	DEVELOPMENT ZONE
BS	ADJACENT ZONE	DB	DEVELOPMENT ZONE
BT	ADJACENT ZONE	DB	DEVELOPMENT ZONE
BU	ADJACENT ZONE	DB	DEVELOPMENT ZONE
BV	ADJACENT ZONE	DB	DEVELOPMENT ZONE
BW	ADJACENT ZONE	DB	DEVELOPMENT ZONE
BX	ADJACENT ZONE	DB	DEVELOPMENT ZONE
BY	ADJACENT ZONE	DB	DEVELOPMENT ZONE
BZ	ADJACENT ZONE	DB	DEVELOPMENT ZONE
CA	ADJACENT ZONE	DB	DEVELOPMENT ZONE
CB	ADJACENT ZONE	DB	DEVELOPMENT ZONE
CC	ADJACENT ZONE	DB	DEVELOPMENT ZONE
CD	ADJACENT ZONE	DB	DEVELOPMENT ZONE
CE	ADJACENT ZONE	DB	DEVELOPMENT ZONE
CF	ADJACENT ZONE	DB	DEVELOPMENT ZONE
CG	ADJACENT ZONE	DB	DEVELOPMENT ZONE
CH	ADJACENT ZONE	DB	DEVELOPMENT ZONE
CI	ADJACENT ZONE	DB	DEVELOPMENT ZONE
CJ	ADJACENT ZONE	DB	DEVELOPMENT ZONE
CK	ADJACENT ZONE	DB	DEVELOPMENT ZONE
CL	ADJACENT ZONE	DB	DEVELOPMENT ZONE
CM	ADJACENT ZONE	DB	DEVELOPMENT ZONE
CN	ADJACENT ZONE	DB	DEVELOPMENT ZONE
CO	ADJACENT ZONE	DB	DEVELOPMENT ZONE
CP	ADJACENT ZONE	DB	DEVELOPMENT ZONE
CQ	ADJACENT ZONE	DB	DEVELOPMENT ZONE
CR	ADJACENT ZONE	DB	DEVELOPMENT ZONE
CS	ADJACENT ZONE	DB	DEVELOPMENT ZONE
CT	ADJACENT ZONE	DB	DEVELOPMENT ZONE
CU	ADJACENT ZONE	DB	DEVELOPMENT ZONE
CV	ADJACENT ZONE	DB	DEVELOPMENT ZONE
CW	ADJACENT ZONE	DB	DEVELOPMENT ZONE
CX	ADJACENT ZONE	DB	DEVELOPMENT ZONE
CY	ADJACENT ZONE	DB	DEVELOPMENT ZONE
CZ	ADJACENT ZONE	DB	DEVELOPMENT ZONE
DA	ADJACENT ZONE	DB	DEVELOPMENT ZONE
DB	ADJACENT ZONE	DB	DEVELOPMENT ZONE
DC	ADJACENT ZONE	DB	DEVELOPMENT ZONE
DD	ADJACENT ZONE	DB	DEVELOPMENT ZONE
DE	ADJACENT ZONE	DB	DEVELOPMENT ZONE
DF	ADJACENT ZONE	DB	DEVELOPMENT ZONE
DG	ADJACENT ZONE	DB	DEVELOPMENT ZONE
DH	ADJACENT ZONE	DB	DEVELOPMENT ZONE
DI	ADJACENT ZONE	DB	DEVELOPMENT ZONE
DJ	ADJACENT ZONE	DB	DEVELOPMENT ZONE
DK	ADJACENT ZONE	DB	DEVELOPMENT ZONE
DL	ADJACENT ZONE	DB	DEVELOPMENT ZONE
DM	ADJACENT ZONE	DB	DEVELOPMENT ZONE
DN	ADJACENT ZONE	DB	DEVELOPMENT ZONE
DO	ADJACENT ZONE	DB	DEVELOPMENT ZONE
DP	ADJACENT ZONE	DB	DEVELOPMENT ZONE
DQ	ADJACENT ZONE	DB	DEVELOPMENT ZONE
DR	ADJACENT ZONE	DB	DEVELOPMENT ZONE
DS	ADJACENT ZONE	DB	DEVELOPMENT ZONE
DT	ADJACENT ZONE	DB	DEVELOPMENT ZONE
DU	ADJACENT ZONE	DB	DEVELOPMENT ZONE
DV	ADJACENT ZONE	DB	DEVELOPMENT ZONE
DW	ADJACENT ZONE	DB	DEVELOPMENT ZONE
DX	ADJACENT ZONE	DB	DEVELOPMENT ZONE
DY	ADJACENT ZONE	DB	DEVELOPMENT ZONE
DZ	ADJACENT ZONE	DB	DEVELOPMENT ZONE

**LINETYPES**

---	SOLID LINE
---	DOTTED LINE
---	DASHED LINE
---	DASH-DOTTED LINE
---	LONG DASH SHORT DASH
---	THICK SOLID LINE
---	THICK DOTTED LINE
---	THICK DASHED LINE
---	THICK DASH-DOTTED LINE
---	THICK LONG DASH SHORT DASH
---	THIN SOLID LINE
---	THIN DOTTED LINE
---	THIN DASHED LINE
---	THIN DASH-DOTTED LINE
---	THIN LONG DASH SHORT DASH
---	THIN THICK SOLID LINE
---	THIN THICK DOTTED LINE
---	THIN THICK DASHED LINE
---	THIN THICK DASH-DOTTED LINE
---	THIN THICK LONG DASH SHORT DASH
---	THIN THIN SOLID LINE
---	THIN THIN DOTTED LINE
---	THIN THIN DASHED LINE
---	THIN THIN DASH-DOTTED LINE
---	THIN THIN LONG DASH SHORT DASH
---	THIN THIN THICK SOLID LINE
---	THIN THIN THICK DOTTED LINE
---	THIN THIN THICK DASHED LINE
---	THIN THIN THICK DASH-DOTTED LINE
---	THIN THIN THICK LONG DASH SHORT DASH

ALL SPACES TO BE SET ASERD  
ALL DRAWINGS REMAIN THE PROPERTY OF CT SURVEYS LTD/INTL.  
CT SURVEYS IS A MEMBER OF



**SURVEY NOTES:**  
This drawing is a plan view of the site and is not to be used for any other purpose without the written consent of the Surveyors.  
The Surveyors have not carried out any investigations into the ground conditions or the stability of the site.  
The Surveyors have not carried out any investigations into the ground conditions or the stability of the site.  
The Surveyors have not carried out any investigations into the ground conditions or the stability of the site.

**SURVEY REVISIONS**

NO.	DESCRIPTION	DATE
1	ISSUED FOR TENDERS	10/10/2022
2	ISSUED FOR TENDERS	10/10/2022
3	ISSUED FOR TENDERS	10/10/2022

**REVISION NOTES:**  
This drawing is a plan view of the site and is not to be used for any other purpose without the written consent of the Surveyors.  
The Surveyors have not carried out any investigations into the ground conditions or the stability of the site.  
The Surveyors have not carried out any investigations into the ground conditions or the stability of the site.

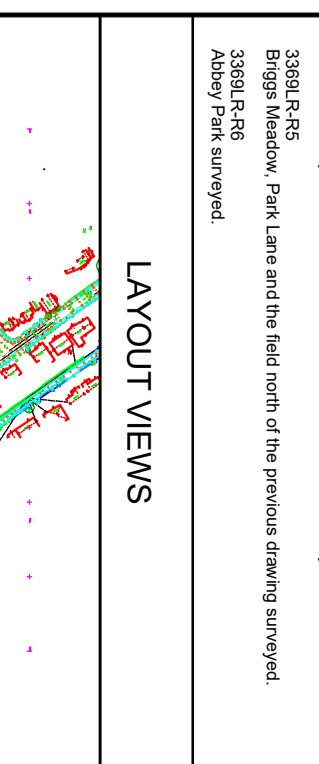

**CT SURVEYS**  
FOR YOUR SURVEYING SOLUTIONS

**UNIT 5  
KILLINGBECK COURT  
LEEDS  
LS14 6PD**

TEL: 0113 440 00 435  
EMAIL: KCB@CTSURVEYS.COM  
WEBSITE: WWW.CTSURVEYS.COM

**Niemenn Architects**  
Abbey Park, Louth, LN11 7BB  
3369LR-R613

1:200 @ A0  
September 2022

